

Owner's Manual

ABI CLASSIC SPREADERS

25/50 CUBIC FOOT GROUND DRIVEN MODELS

MANUFACTURED BEFORE APRIL 24, 2016

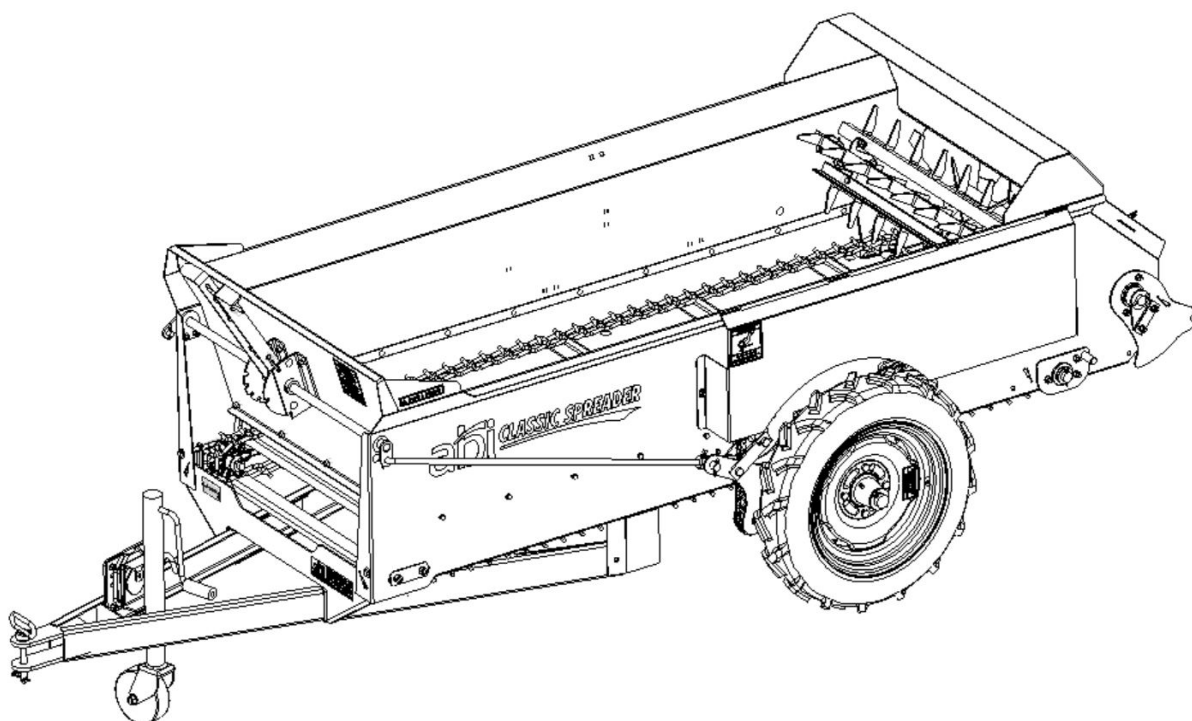

NOTE: This Owner's Manual covers several models. Features may vary by model. Not all features in this manual are applicable to all models and the model depicted may differ from yours.

For Your Records

Located on the front lower left corner of the unit is an ID plate showing the serial number. Record your machine’s information and serial number in the space provided below. ABI will use this information to give you prompt, efficient service when you order parts or need product support.

Model and Serial Number

Model Number:

Serial Number:

Invoice Number:

Purchaser’s Name:

Contact Information

ABI Attachments, Inc
520 S. Byrkit Ave.
Mishawaka, IN 46544

Customer Support

Email: abicutomerservice@abiattachments.com
Phone: 877-788-7253
Website: www.abisupport.com

Table of Contents

ForYourRecords.....	2
Safety.....	3
LubricationGuide.....	6
BodyAssembly.....	7
Web&FloorAssembly.....	8
Axle Assembly.....	9
Lever Assembly.....	10
Idler Arm Assembly.....	11
WebDriveAssembly.....	12
Footnotes.....	13

Product Manual Information

NOTE: This operators manual covers several models, Features may vary by model. Not all features in this manual are applicable to all models depicted may differ from yours.

Safety



WARNING! The **SAFETY ALERT SYMBOL** indicates there is a potential hazard to personal safety involved and extra safety precaution must be taken. When you see this symbol, be alert and carefully read the message that follows it. In addition to design and configuration of equipment, hazard control, and accident prevention are dependent upon the awareness, concern, prudence, and proper training of personnel involved in the operation, transport, maintenance, and storage of equipment.



CALIFORNIA PROPOSITION 65

WARNING! Cancer and reproductive harm- www.P65Warnings.ca.gov

SAFETY AT ALL TIMES

Careful operation is your best assurance against an accident. All operators, no matter how much experience they may have, should carefully read this manual and other related manuals, or have the manuals read to them, before operating the tow vehicle and this implement.

- Thoroughly read and understand the “Safety Label” section. Read all instructions noted on them.
- Do not operate the equipment while under the influence of drugs or alcohol as they impair the ability to safely and properly operate the equipment.
- The operator should be familiar with all functions of the tow vehicle and attached implement and be able to handle emergencies quickly.
- Make sure all guards and shields appropriate for the operation are in place and secured before operating implement.
- Keep all bystanders away from equipment and work area.
- Start tow vehicle from the driver’s seat with hydraulic controls in neutral.
- Operate tow vehicle and controls from the driver’s seat only.
- Never dismount from a moving tow vehicle or leave tow vehicle unattended with engine running.
- Do not allow anyone to stand between tow vehicle and implement while backing up to implement.
- Keep hands, feet, and clothing away from power-driven parts.
- While transporting and operating equipment, watch out for objects overhead and along side such as fences, trees, buildings, wires, etc.
- Do not turn tow vehicle so tight as to cause hitched implement to ride up on the tow vehicle’s rear wheel.
- Store implement in an area where children normally do not play. When needed, secure attachment against falling with support blocks.

SAFETY PRECAUTIONS FOR CHILDREN

Tragedy can occur if the operator is not alert to the presence of children. Children generally are attracted to implements and their work.

- Never assume children will remain where you last saw them.
- Keep children out of the work area and under the watchful eye of a responsible adult.
- Be alert and shut the implement and tractor down if children enter the work area.
- Never carry children on the tractor or implement. There is not a safe place for them to ride. They may fall off and be run over or interfere with the control of the tow vehicle.
- Never allow children to operate the tow vehicle or implement, even under adult supervision.
- Never allow children to play on the tow vehicle or implement.
- Use extra caution when backing up. Before the tractor starts to move, look down and behind to make sure the area is clear.

SHUTDOWN & STORAGE

- If engaged, disengage power take-off.
- Park on solid, level ground and lower implement to ground or onto support blocks.
- Put tractor in park or set park brake, turn off engine, and remove switch key to prevent unauthorized starting.
- Relieve all hydraulic pressure to auxiliary hydraulic lines
- Wait for all components to stop before leaving operator’s seat.
- Use steps, grab-handles and anti-slip surfaces when stepping on and off the tractor.
- Detach and store implement in an area where children normally do not play. Secure implement using blocks and supports.

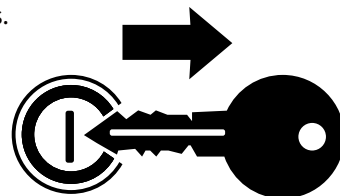

TIRE SAFETY

- Tire changing can be dangerous and must be performed by trained personnel using the correct tools and equipment.
- Always maintain correct tire pressure. Do not inflate tires above recommended pressures shown in the Operator's Manual.
- When inflating tires, use a clip-on chuck and extension hose long enough to allow you to stand to one side and NOT in front of or over the tire assembly. Use a safety cage if available.
- Securely support the implement when changing a wheel.
- When removing and installing wheels, use wheel handling equipment adequate for the weight involved.
- Make sure wheel bolts have been tightened to the specified torque.
- Some attachments may have foam or sealant inside them and must be disposed of properly.

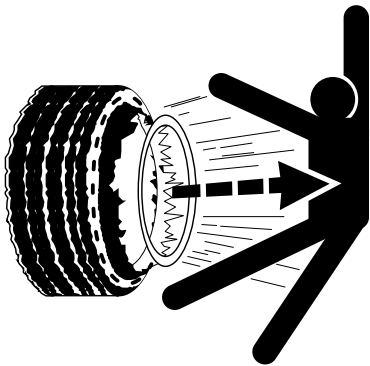

OPERATION SAFETY

- Stay alert for holes, rocks, and roots in the terrain and other hidden hazards. Keep away from drop-offs.
- Stop implement immediately upon striking an obstruction. Turn engine off, remove key, inspect and repair any damage before resuming operation.
- Never operate tractor and implement under trees with low hanging limbs. Operators can be knocked off the tractor and then run over by implement.

TRANSPORT SAFELY

- Comply with federal, state, and local laws.
- Use towing vehicle and trailer of adequate size and capacity. Secure equipment towed on a trailer with tie downs and chains.
- Sudden braking can cause a towed trailer to swerve and upset. Reduce speed if towed trailer is not equipped with brakes.
- Avoid contact with any overhead utility lines or electrically charged conductors.
- Always drive with load on end of loader arms low to the ground.
- Always drive straight up and down steep inclines with heavy end of a tow vehicle with loader attachment on the "uphill" side.
- Engage park brake when stopped on an incline.
- Maximum transport speed for an attached equipment is 20 mph. **DO NOT EXCEED.** Never travel at a speed which does not allow adequate control of steering and stopping. Some rough terrains require a slower speed.
- As a guideline, use the following maximum speed weight ratios for attached equipment:
 - **20 mph** when weight of attached equipment is less than or equal to the weight of machine towing the equipment.
 - **10 mph** when weight of attached equipment exceeds weight of machine towing equipment but not more than double the weight.
- **IMPORTANT:** Do not tow a load that is more than double the weight of the vehicle towing the load.

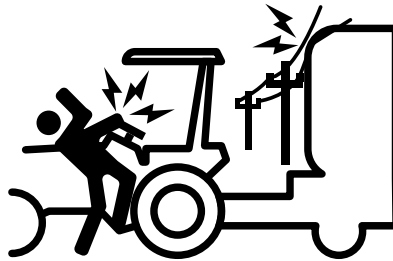

PRACTICE SAFE MAINTENANCE

- Understand procedure before doing work. Refer to the Operator's Manual for additional information.
- Work on a level surface in a clean dry area that is well-lit.
- Lower implement to the ground and follow all shutdown procedures before leaving the operator's seat to perform maintenance.
- Do not work under any hydraulic supported equipment. It can settle, suddenly leak down, or be lowered accidentally. If it is necessary to work under the equipment, securely support it with stands or suitable blocking beforehand.
- Use properly grounded electrical outlets and tools.
- Use correct tools and equipment for the job that are in good condition.
- Allow equipment to cool before working on it.
- Disconnect battery ground cable (-) before servicing or adjusting electrical systems or before welding on implement.
- Inspect all parts. Make certain parts are in good condition & installed properly.
- Replace parts on this implement with genuine ABI Attachments parts only.
- Do not alter this implement in a way which will adversely affect its performance.
- Do not grease or oil implement while it is in operation.
- Remove buildup of grease, oil, or debris.
- Always make sure any material and waste products from the repair and maintenance of the implement are properly collected and disposed.
- Remove all tools and unused parts before operation.



PREPARE FOR EMERGENCIES

- Be prepared if a fire starts.
- Keep a first aid kit and fire extinguisher handy.
- Keep emergency numbers for doctor, ambulance, hospital, and fire department near phone.



USE SAFETY LIGHTS AND DEVICES

- Slow moving tractors, skid steers, self-propelled machines, and towed equipment can create a hazard when driven on public roads. They are difficult to see, especially at night. Use the Slow Moving Vehicle sign (SMV) when on public roads.
- Flashing warning lights and turn signals are recommended whenever driving on public roads.



AVOID UNDERGROUND UTILITIES

- **Dig Safe, Call 811 (USA)** Always contact your local utility companies (electrical, telephone, gas, water, sewer, and others) before digging so that they may mark the location of any underground services in the area.
- Be sure to ask how close you can work to the marks they positioned.



WEAR PERSONAL PROTECTION EQUIPMENT (PPE)

- Wear protective clothing and equipment appropriate for the job such as safety shoes, safety glasses, hard hat, and ear plugs.
- Clothing should fit snug without fringes and pull strings to avoid entanglement with moving parts.
- Prolonged exposure to loud noise can cause hearing impairment or hearing loss. Wear suitable hearing protection such as earmuffs or earplugs.
- Operating equipment safely requires the operator's full attention. Avoid wearing headphones while operating equipment.



USE SEAT BELT AND ROPS

- ABI Attachments recommends the use of a CAB or roll-over protective structures (ROPS) and seat belt in almost all tow vehicles. Combination of a CAB or ROPS and seat belt will reduce the risk of serious injury or death if the tow vehicle should be upset.
- If ROPS is in the locked-up position, fasten seat belt snugly and securely to help protect against serious injury or death from falling and machine overturn.

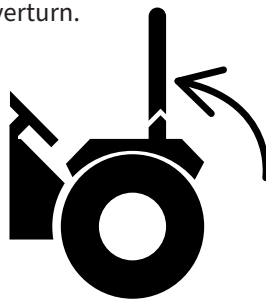

AVOID HIGH PRESSURE FLUIDS HAZARD

- Escaping fluid under pressure can penetrate the skin causing serious injury.
- Before disconnecting hydraulic lines or performing work on the hydraulic system, be sure to release all residual pressure.
- Make sure all hydraulic fluid connections are tight and all hydraulic hoses and lines are in good condition before applying pressure to the system.
- Use a piece of paper or cardboard, NOT BODY PARTS, to check for suspected leaks.
- Wear protective gloves and safety glasses or goggles when working with hydraulic systems.
- DO NOT DELAY. If an accident occurs, see a doctor familiar with this type of injury immediately. Any fluid injected into the skin or eyes must be treated within a few hours or gangrene may result.



KEEP RIDERS OFF MACHINERY

- Never carry riders on tractor or implement.
- Riders obstruct operator's view and interfere with the control of the tow vehicle.
- Riders can be struck by objects or thrown from the equipment. Never use tractor or implement to lift or transport riders.

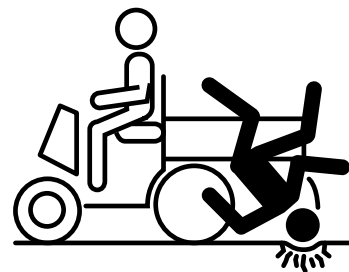

Lubrication Guide



- Grease every 20 or 30 loads and before storage.
- Oil all chains daily.
- Clean and oil box every 30 days and before storage.

= Grease Zerk
Location

Body Assembly

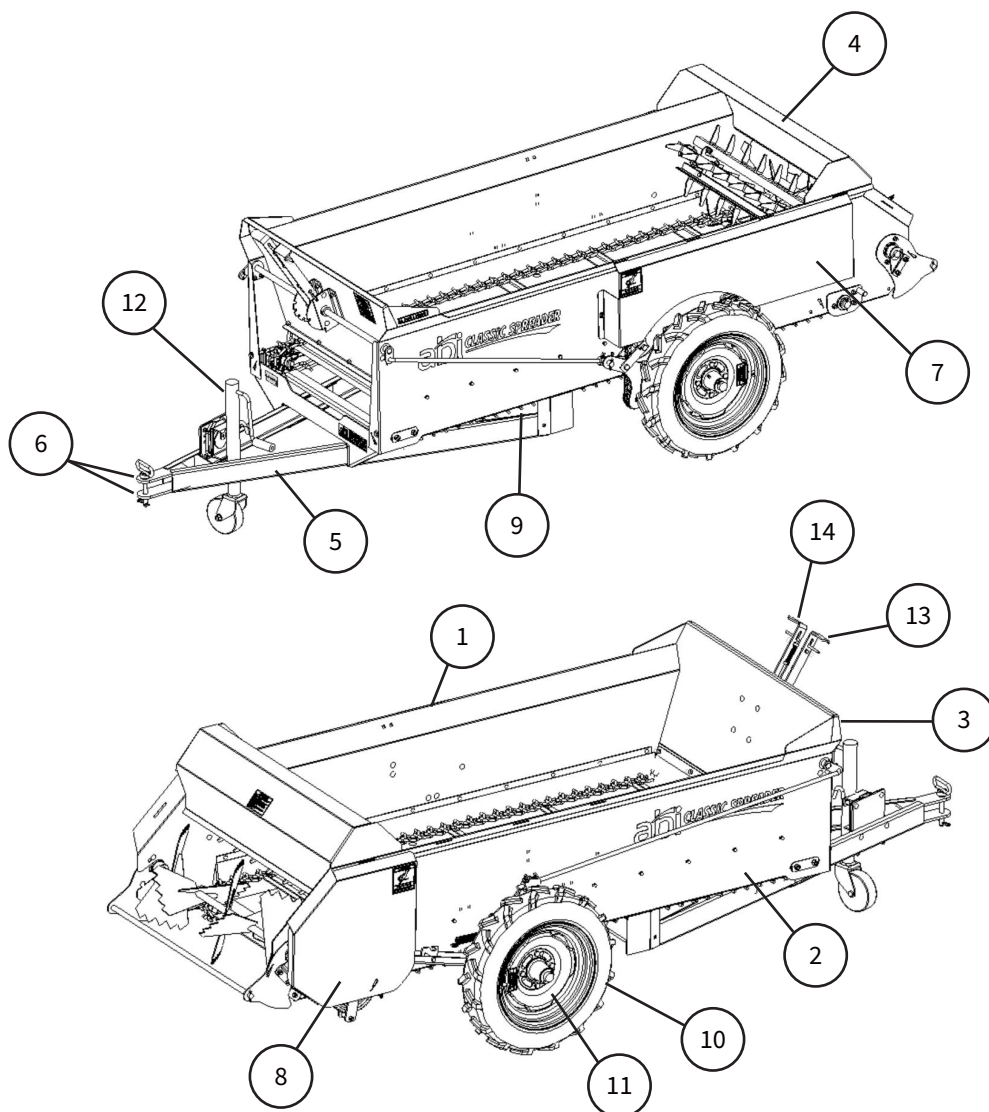

ITEM	PART #	DESCRIPTION
1		RIGHT SIDE BODY
2		LEFT SIDE BODY
3		FRONT END
4		SHREDDER SHIELD
5		HITCH
6		HITCH PLATES
7	LSP26MCS (25GD)	CHAIN SHIELD
7	LSP56MCS (50GD)	CHAIN SHIELD

ITEM	PART #	DESCRIPTION
8	LSP26WDS (25GD)	DRIVE CHAIN SHIELD
8	LSP56WDS (50GD)	DRIVE CHAIN SHIELD
9		WEB SLIDE
10		RUBBER WHEELS 5.00-15
11		STEEL RIM 15 X 4.5 WHL
12		JACK
13		WEB ENGAGE LEVER
14		BEATER ENGAGE LEVER

Web & Floor Assembly

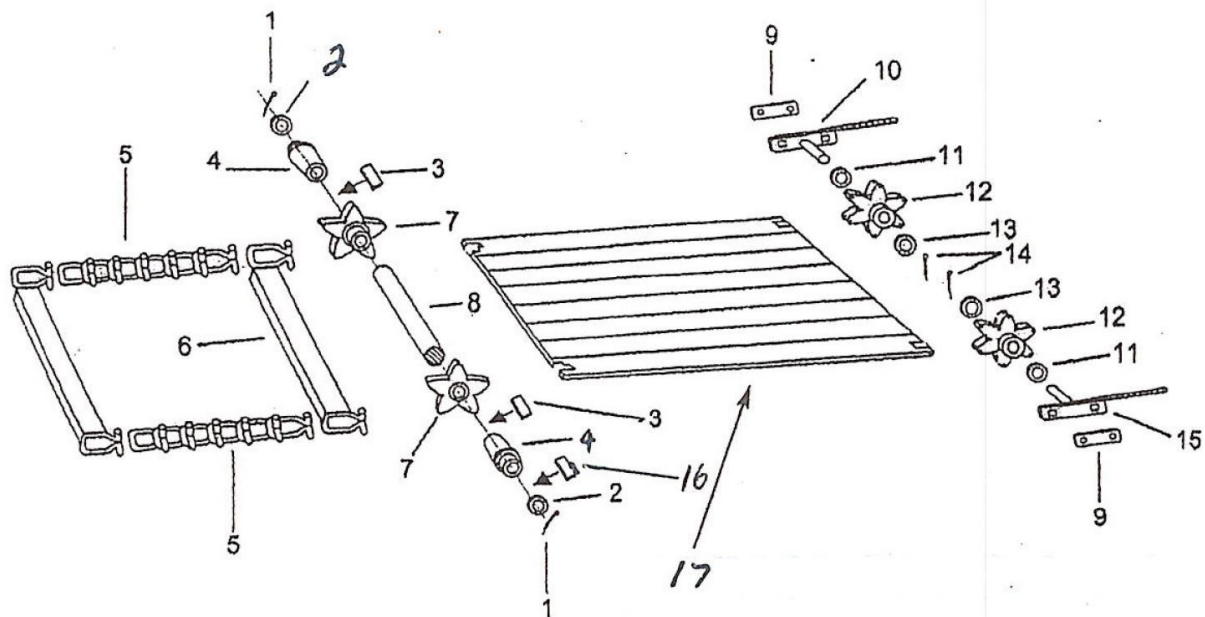

ITEM	PART #	DESCRIPTION
1	CP-250-150	1/4" X 1-1/2" COTTER PIN
2	N14-1125P	1-1/8" MACHINE WASHER
3	KS250-150	1/4" 1-1/2" KEY STOCK
4	LC331106	331 WEB BEARING 1-1/16"
5	TRP375	3/8" TEE ROD LINKS
6	TS25 (25GD)	#25 WEB SLATS
6	TS50 (50GD)	#50/65 WEB SLATS
7	LC315106	5 TOOTH WEB DRIVE SPROCKET
8	LS25WDS (25GD)	#25 WEB DRIVE SHAFT
8	LS50WDS (50GD)	#50/65 WEB DRIVE SHAFT
9	LSPWIP	WEB IDLER PLATE

ITEM	PART #	DESCRIPTION
10	LSPWIPL	LEFT WEB IDLER BRACKET
10A	LSPWIBL-C	LEFT WEB IDLER (COMPLETE ASSEMBLY)
11	SC 075	3/4" SHAFT COLLAR
12	LS313275	WEB IDLER SPROCKET
13	N14-0750P	3/4" MACHINE WASHER
14	CP-187-125	3/16" X 1-1/4" COTTER PIN
15	LSPWIBR	RIGHT WEB IDLER BRACKET
15A	LSPWIB-C	RIGHT WEB IDLER (COMPLETE ASSEMBLY)
16	KS250-100	1/4" X 1" KEY STOCK
17	PF25 (25GD)	3/4" X 6" X 59" POLY FLOOR
17	PF50 (50GD)	3/4" X 6" X 76" POLY FLOOR

Axle Assembly

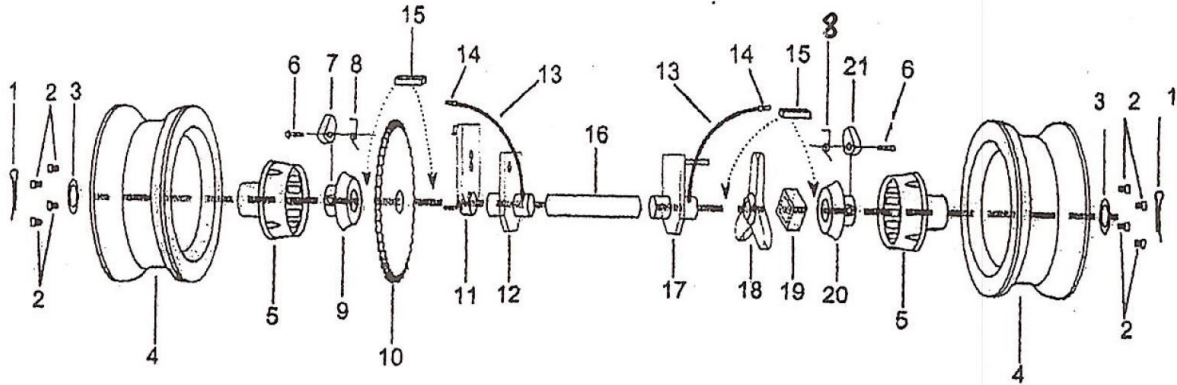

ITEM	PART #	DESCRIPTION
1	CP-250-175	1/4" X 1-3/4" COTTER PIN
2	A888BO	1/2" WHEEL BOLTS
3	LSP137SW	SHAFT/COTTER PIN WASHER
4	W1545W	15" X 4.5" 4 BOLT RIM, WHITE
5	LC50RH	4 ON 5 RATCHETING WHEEL HUB
6	HB 250-200	1/4-20 X 2" HEX BOLT
7	LC50WPL	SMALL WHEEL PAWL, LEFT
8	SL1516	WHEEL PAWL SPRING
9	LS50HBL	HUB BACKER LEFT
10	60B60X137	AXLE SPROCKET
11	LSP55DA	CHAIN DISENGAGE ARM

ITEM	PART #	DESCRIPTION
12	LSP55ABPL	LEFT AXLE BEARING PLATE
13	FGH82012	12" GREASE HOSE
14	GFH1618	1/8" GREASE FITTING FEMALE
15	KS312-375	5/16" X 3-3/4" KEY STOCK
16	LS25A (25GD)	#25 AXLE (OLD STYLE)
16	LS50A (50GD)	#50 AXLE (OLD STYLE)
17	LSP55ABPR	RIGHT AXLE BEARING PLATE
18	LSP25S	WEB DRIVE STAR
19	SB11258	5/8" AXLE SPACER
20	LC50HBR	HUB BACKER RIGHT
21	LC50WPR	SMALL WHEEL PAWL, LEFT

Lever Assembly

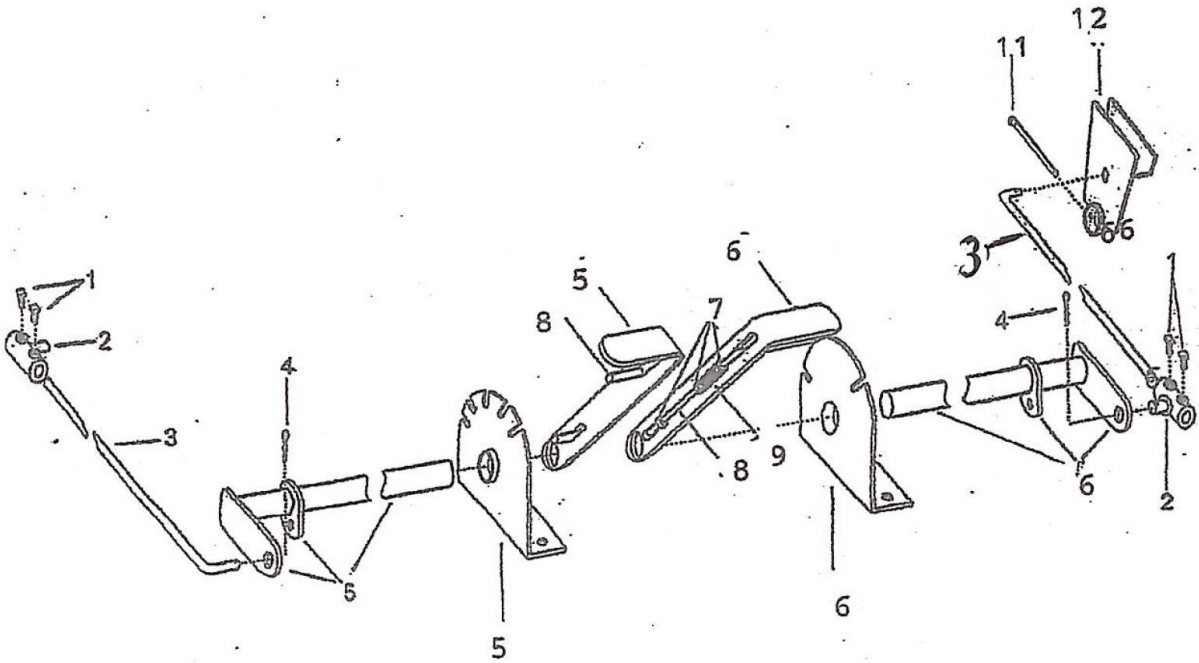

ITEM	PART #	DESCRIPTION
1	SS313-075Z	5/16" X 3/4" SQ HD SET SCREW
2	LC8C3	DOUBLE SET COLLAR
3	LR5650 (25GD)	9/16" X 50" LEVER ROD (50 OLD STYLE)
3	LR5659 (50GD)	9/16" X 59" LEVER ROD (25 OLD STYLE)
4	CP-187-100	3/16" X 1" COTTER PIN
5	LA25W (25GD)	#25 WEB LEVER ASSEMBLY
5	LA50W (50GD)	#50 WEB LEVER ASSEMBLY

ITEM	PART #	DESCRIPTION
6	LA25C (25GD)	#25 CHAIN LEVER ASSEMBLY
6	LA50C (50GD)	#50 CHAIN LEVER ASSEMBLY
7	SC 037	3/8" SHAFT COLLAR
8	LR31H	5/16" LEVER ROD HANDLE
9	SL6812143	25/50 LEVER HANDLE SPRING
10		
11	GFH1684	1/8" X 2-1/4" GREASE FITTING
12	LSP55DA	25/50 DISENGAGE ARM

Idler Arm Assembly

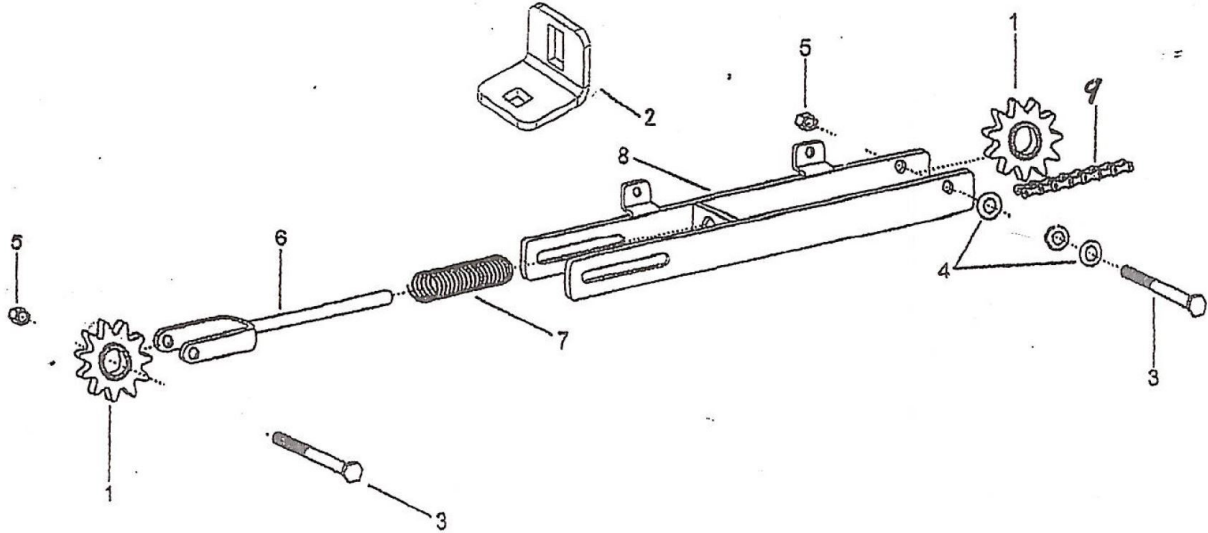

ITEM	PART #	DESCRIPTION
1	60BB11X50	#60 X 11 IDLER SPROCKET
2	LSPDCAH-1	LEG FOR SPRING IDLER ARM
3	HB 500-225	1/2" X 2-1/4" HEX BOLT
4	FL 500	1/2" USS FLAT WASHER
5	LN 500	1/2" LOCK NUT
6	LSPDCAC	IDLER ARM CLEAVES
7	SL121410	IDLER ARM SPRING
8	LSPDCA	IDLER ARM HOUSING
8A	LSPDCA-C	IDLER ARM (COMPLETE ASSEMBLY)
9	RC6079 (25GD)	#25 MAIN DRIVE CHAIN
9	RC6097 (50GD)	#50 MAIN DRIVE CHAIN

Web Drive Assembly

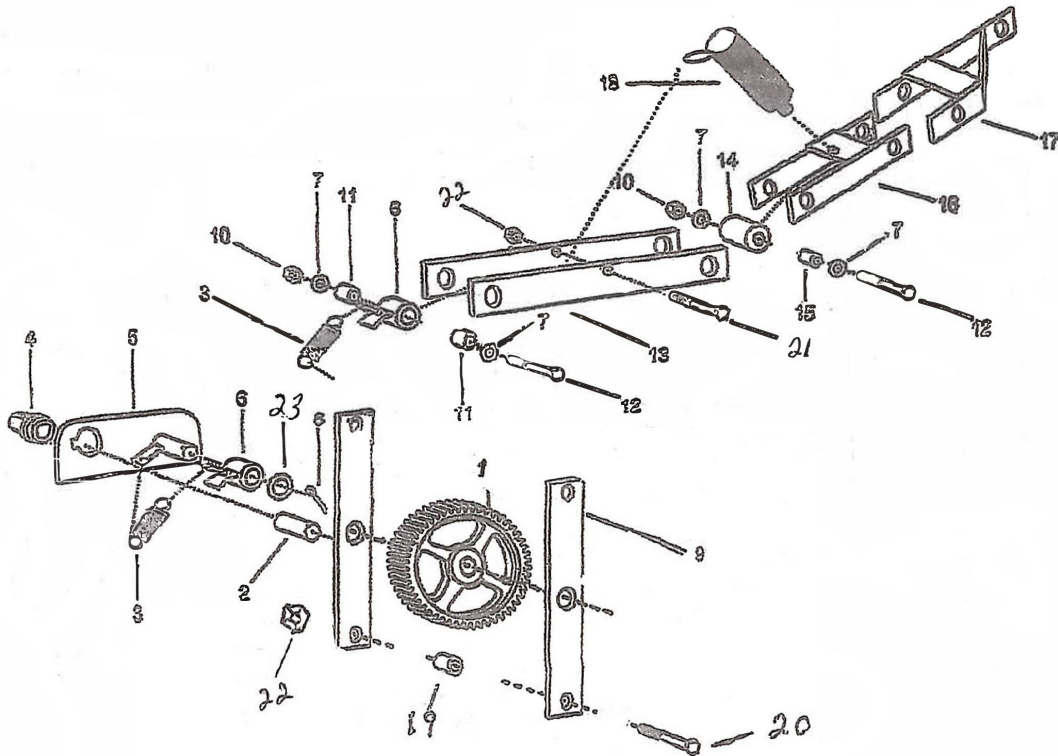

ITEM	PART #	DESCRIPTION
1	LC25RG	SMALL WEB RATCHET GEAR
2	LS25WDS (25GD)	#25 WEB DRIVE SHAFT
2	LS50WDS (50GD)	#50/65 WEB DRIVE SHAFT
3	SL1439	WEB PAWL SPRING
4	LC331106	331 WEB SHAFT BEARING 1-1/16"
5	LSP55RWBP	WEB BEARING, RETAINING PAWL BRACKET
6	WP50D	WEB DRIVE PAWL
7	FW 500	1/2" FLAT WASHER
8	CP-187-125	3/16" X 1-1/4" COTTER PIN
9	LSP56PA	PAWL CONTROL ARM
10	LN 500	1/2" LOCK NUT
11	BB1278114	1/2" X 7/8" X 1-1/4" BUSHING
12	HB 500-325	1/2" X 3-1/4" HEX BOLT

ITEM	PART #	DESCRIPTION
13	LSP25WPA (25GD)	#25 WEB PUSH ARM
13	LSP50WPA (50GD)	#50 WEB PUSH ARM
14	LC514	SMALL WEB ROLLER
15	SB1278212	1/2" X 7/8" X 2-1/2" STEEL BUSHING
16	LSP56WRA	WEB ROLLER ARM
17	LSP25YA	YOKE ARM
18	SL955	WEB ARM EXTENSION SPRING
19	SB38158	3/8" I.D. X 1-5/8" LONG SPACER
20	HB 375-250	3/8" X 2-1/2" HEX BOLT
21	HB 375-325	3/8" X 3-1/4" HEX BOLT
22	HN 375	3/8" HEX NUT
23	N14 0750P	3/4" MACHINE WASHER

Foot Notes

[illegible]

Contact Information

ABI Attachments, Inc
520 S. Byrkit Ave.
Mishawaka, IN 46544

Customer Support

Email: support@abiattachments.com
Phone: 877-788-7253
Website: www.abisupport.com

To order parts or to speak to one of ABI's Customer Service Representatives contact us Monday to Friday 9am to 5pm EST.

For additional information on the use or setup of this implement, please contact the ABI customer support team at 855.211.0598.

Additional support videos are available at the ABI support page (abisupport.com) under each tool.

Warranty Information and Return Policy - Warranty and return policy information can also be found on the ABI support page under each tool. For additional questions regarding warranty or return policy, contact the ABI customer support team at 855.211.0598.

